



## CUTTING SYSTEM



## 300 SERIES FEATURES

These little monsters bring the brush torturing performance of Brush Fire to smaller carriers. Designed to make the most of lower hp and flow, the 300 series have what it takes to get the job done. The cutting system was redesigned to focus on the needs of smaller carriers. Like all Brush Fires the 300 series have rows and rows of teeth laid out in a staggered spiral.

THE RIGHT EQUIPMENT

## - 300 Series Features

**BAUMALIGHT™**



### **Green Teeth**

The concave shaped carbide tip provides aggressive brush mulching action by chipping the brush bit by bit. Part of the secret of their performance is always having a sharp edge to make mulching easier. Sharper edges result in more aggressive cutting on low flow. These round carbide tipped teeth are like having 3 teeth in one. Just loosen the lock nut, turn the tooth, tighten and tear back into the brush. It takes only seconds to sharpen the tooth this way and the tooth can be rotated up to three times to provide renewed cutting performance. This gives you 3 times the wear, letting you tear into brush 3 times longer.

The tool holders are left or right positional and are designed to work in pairs. Being bolt on replaceable in case of damage makes servicing quick and easy without special tools and can even be done in the field.

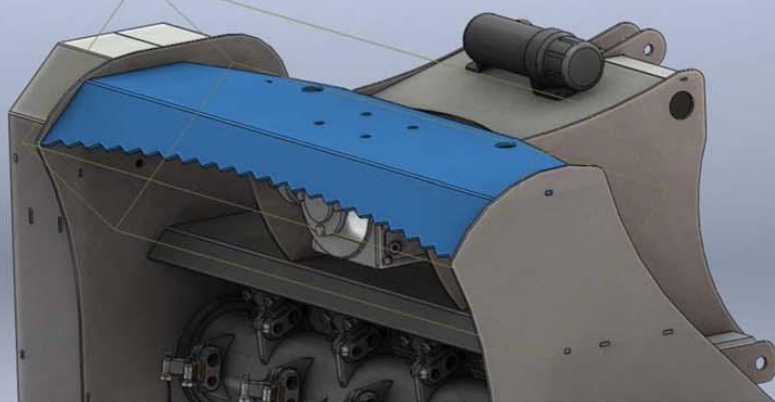

### **Integrated Brush Bar**

When push comes to shove the integrated brush bar helps control the brush and bend taller brush for easier mulching.



### **Integrated Skid Shoes**

These durable skid shoes help the Brush Fire to better float over the ground for optimal mulching action.

**BAUMALIGHT™**



**MS 348**

When you are on a budget for hydraulic power, the MS348 gets you to the bottom line. Designed for skid steers with flows between 12 and 20 GPM, this Brush Fire is ready to tear it up. Ruggedly built and ready to clear a path through brush up to 2" in diameter, be glad this Brush Fire is on your side.

## SKID STEER



### Specifications

Model No.	MS348
Path Width	60"
Rotor Width	48"
Maximum Engine HP	Check GPM & PSI
Minimum Engine HP	30 HP
Cutting Depth	Level
Number of Cutters	60
Slashes Per Second	800 - 1200
Hitch Type	Skid Steer
Hitch Size	Universal
Dive Speed	Check GPM & PSI
System Protection	Built-in Relief
Shipping Size (LxWxH)	62" x 40" x 40"
Unit Weight	950 LBS.



**THE RIGHT EQUIPMENT**

**300  
SERIES**

**BAUMALIGHT**



## SkidSteer | Maximum Brush Cutting Sizes

Double tree size for 'stop & chew' cutting \*\*

Hydraulics	Operation	12 GPM	15 GPM	18 GPM	20 GPM	21 GPM
2500 PSI	Slow Forward	0.75"	1"	1.25"	1.5"	N/A*
3000 PSI	Slow Forward	1"	1.25"	1.5"	2"	N/A*
	<b>RPM</b>	832 RPM	924 RPM	1088 RPM	1215 RPM	

\*\*Do not double for top down mulching with excavators.

\*NOTICE: This value must never be exceeded or warranty is void.



**BAUMALIGHT**