



CUTTING SYSTEM



300 SERIES FEATURES

These little monsters bring the brush torturing performance of Brush Fire to smaller carriers. Designed to make the most of lower hp and flow, the 300 series have what it takes to get the job done. The cutting system was redesigned to focus on the needs of smaller carriers. Like all Brush Fires the 300 series have rows and rows of teeth laid out in a staggered spiral.

THE RIGHT EQUIPMENT

- 300 Series Features

BAUMALIGHT™

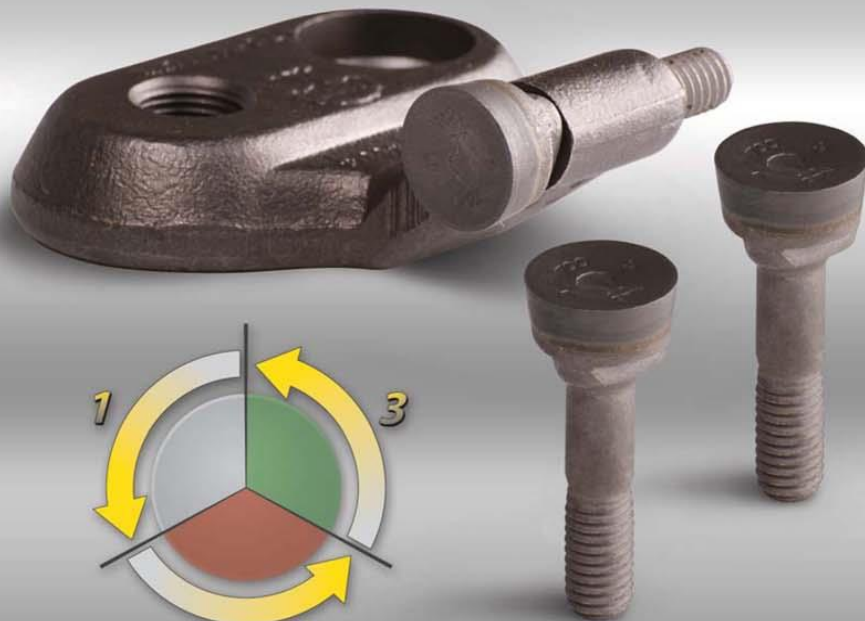

Green Teeth

The concave shaped carbide tip provides aggressive brush mulching action by chipping the brush bit by bit. Part of the secret of their performance is always having a sharp edge to make mulching easier. Sharper edges result in more aggressive cutting on low flow. These round carbide tipped teeth are like having 3 teeth in one. Just loosen the lock nut, turn the tooth, tighten and tear back into the brush. It takes only seconds to sharpen the tooth this way and the tooth can be rotated up to three times to provide renewed cutting performance. This gives you 3 times the wear, letting you tear into brush 3 times longer.

The tool holders are left or right positional and are designed to work in pairs. Being bolt on replaceable in case of damage makes servicing quick and easy without special tools and can even be done in the field.

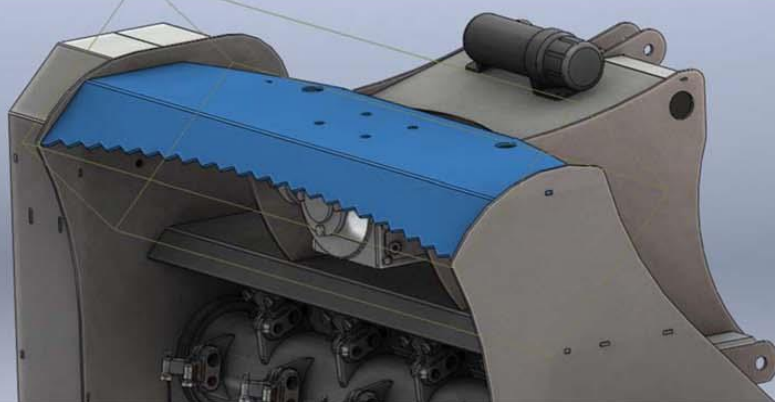

Integrated Brush Bar

When push comes to shove the integrated brush bar helps control the brush and bend taller brush for easier mulching.



Integrated Skid Shoes

These durable skid shoes help the Brush Fire to better float over the ground for optimal mulching action.

BAUMALIGHT™



EXCAVATOR



Just when brush thought it was safely out of your reach, here comes the MX330. When paired with a Mini Excavator it won't be easy for the brush to play hard to get. With the control and precision of the excavator and the brush eliminating power of Brush Fire, mulching around objects is not a problem. In a ditch or overhead Brush Fire is coming to get it.

Excavator | Maximum Brush Cutting Sizes

Double tree size for 'stop & chew' cutting **

Hydraulics	Operation	12 GPM	15 GPM	18 GPM	20 GPM	21 GPM
2500 PSI		0.75"	1"	1.25"	1.5"	N/A*
3000 PSI		1"	1.25"	1.5"	2"	N/A*
	RPM	832 RPM	924 RPM	1088 RPM	1215 RPM	

**Do not double for top down mulching with excavators.

*NOTICE: This value must never be exceeded or warranty is void.



THE RIGHT EQUIPMENT

300 SERIES

Specifications

Model No.	MX330
Path Width	38"
Rotor Width	30"
Maximum Engine HP	Check GPM & PSI
Minimum Engine HP	10 HP
Cutting Depth	Level
Number of Cutters	36
Slashes Per Second	600 - 1000
Hitch Type	Excavator
Hitch Size	Universal
Dive Speed	Check GPM & PSI
System Protection	Built in Relief
Shipping Size (LxWxH)	42"x 30"x 36"
Unit Weight	750 LBS.

BAUMALIGHT™



Mounting Options

Weld any existing mount to the BAUMALIGHT flat plate, providing countless options, value and economy. Contact your nearest authorized BAUMALIGHT dealer for specific information about all other mounting systems specific to your machine.



BAUMALIGHT™